

FLANGE-CAST IRON

INSERT-RUBBER

## HRC - Standard straight bore series (lengthen type)

SIZE	MAX BORE		DIMENSIONS								MASS KG
	MM	INS	A	B	E	F	G	C	D	L	
70	32	1 1/4	69	60	31	25	18	20.0	23.5	65	1.20
90	42	1 5/8	85	70	32	30.5	22.5	26.0	30.0	82.5	1.68
110	55	2 1/8	112	100	45	45	29	37.0	45.0	119.0	7.20
130	60	2 3/8	130	105	50	53	36	47.0	55.5	147.0	7.86
150	70	2 3/4	150	115	62	60	40	50.0	60.0	160.0	10.25
180	80	3 1/8	180	125	77	73	49	58.0	70.0	189.0	23.90
230	100	4"	225	155	99	85.5	59.5	77.0	90.0	239.5	37.44
280	130	5"	275	206	119	105.5	74.5	90.0	105.5	285.5	72.00

## HRC - Straight bore or taper bore (universal series)

SIZE	MAX BORE		DIMENSIONS								MASS KG
	MM	INS	A	B	E	F	G	C	D	L	
70	32	1 1/4	69	60	31	25	18	20.0	23.5	65	1.20
90	42	1 5/8	85	70	32	30.5	22.5	19.5	23.5	69.5	1.40
110	55	2 1/8	112	100	45	45	29	18.5	26.5	82	6.00
130	60	2 3/8	130	105	50	53	36	18.0	26.5	89	6.55
150	70	2 3/4	150	115	62	60	40	23.5	33.5	107	8.53
180	80	3 1/8	180	125	77	73	49	34.5	46.5	142	19.92
230	100	4"	225	155	99	85.5	59.5	39.5	52.5	164.5	31.20
280	130	5"	275	206	119	105.5	74.5	51.0	66.5	207.5	60.00

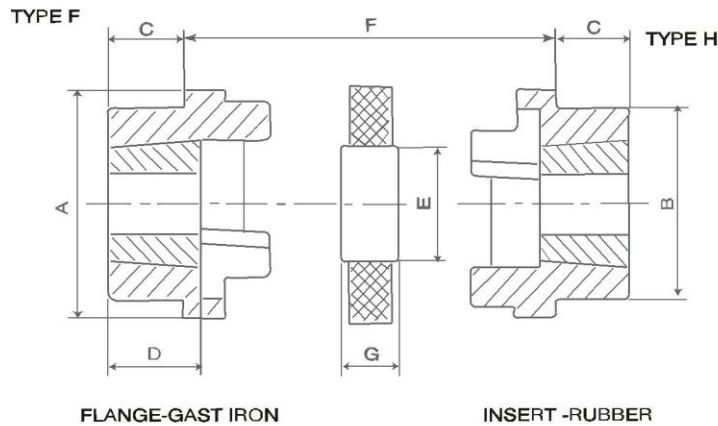

## HRC - Taper bore universal series

Size	Bush	A	B	E	F	G	C	D	J	Max bore		L	Maximum misalignment		Max Revolution n(rpm)	Moment of inertia (kg.cm <sup>2</sup> )	G (Kg)
										mm	inch		Parallel	Axial			
70	1008	69	60	31	25	18	20	23.5	29	25	1	65	0.3	+0.2	9100	8.5	1.00
90	1108	85	70	32	30.5	22.5	19.5	23.5	29	28	1 1/8	69.5	0.3	+0.5	7400	11.5	1.17
110	1610	112	100	45	45	29	18.5	26.5	38	42	1 5/8	82	0.3	+0.6	5630	40	5.00
130	1610	130	105	50	53	36	18	26.5	38	42	1 5/8	89	0.4	+0.8	4850	78	5.46
150	2012	150	115	60	60	40	23.5	33.5	42	50	2	107	0.4	+0.9	4200	181	7.11
180	2517	180	125	77	73	49	34.5	46.5	48	60	2 1/2	142	0.4	+1.1	3500	434	16.60
230	3020	225	155	99	85.5	59.5	39.5	52.5	55	75	3	165	0.5	+1.3	2800	1207	26.00
280	3525	275	206	119	106	74.5	51	66.5	67	100	4	208	0.5	+1.7	2300	4465	50.00

J-the wrench clearance required for tightening and loosening the bush on the shaft.

$$L=2C+f$$

### POWER RATINGS(KW)

SPEED rev/min	Coupling Size							
	70	90	110	130	150	180	230	280
100	0.33	0.84	1.68	3.30	6.28	9.95	20.9	33.0
200	0.66	1.68	3.35	6.60	12.6	19.9	41.9	65.0
400	1.32	3.35	6.70	13.2	25.1	39.8	83.8	132
600	1.98	5.03	10.1	19.8	37.7	59.7	126	198
720	2.37	6.03	12.1	23.8	45.2	71.6	151	238
800	2.64	6.70	13.4	26.4	50.3	79.6	168	264
960	3.17	8.04	16.1	31.7	60.3	95.5	201	317
1200	3.96	10.1	20.1	39.6	75.4	119	251	396
1440	4.75	12.1	24.1	47.5	90.5	143	302	475
1600	5.28	13.4	26.8	52.8	101	159	335	528
1800	5.94	15.1	30.2	59.4	113	179	377	594
2000	6.60	16.8	33.5	66.0	126	199	419	660
2200	7.26	18.4	36.9	72.6	138	219	461	726
2400	7.92	20.1	40.2	79.2	151	239	503	
2600	8.58	21.8	43.6	85.8	163	259	545	
2880	9.50	24.1	48.3	95	181	286		
3000	9.90	25.1	50.3	99	188	298		
3600	11.9	30.1	60.3	118	226			
Nominal Torque(Nm)	31.5	80	160	315	600	950	2000	3150
Max Torque(Nm)	72	180	360	720	1500	2350	5000	7200